

Stem types for Gas thermometers with capillary

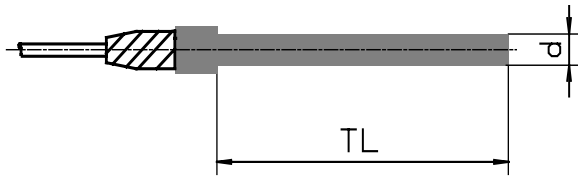

Stem type F1
plain stem without thread

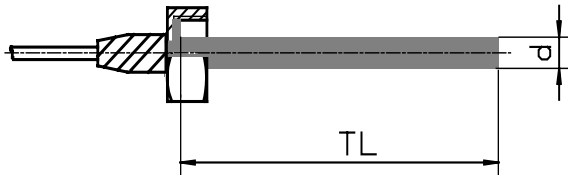

Stem type F4
union nut

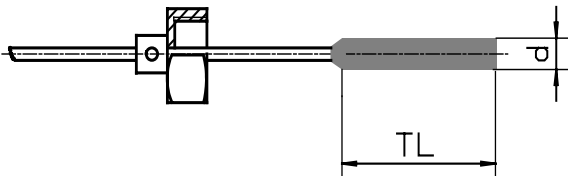

Stem type F4-1
displacable union nut
on capillary

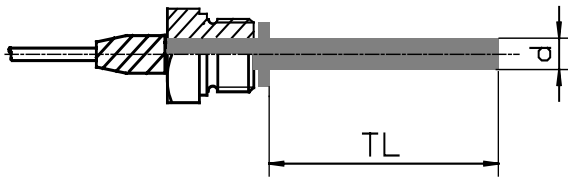

Stem type F5
rotating thread
only with extra thermowell

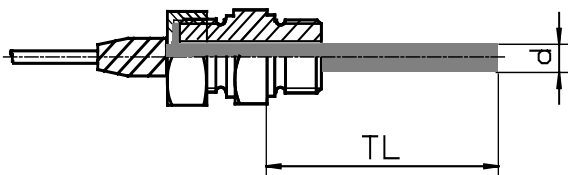

Stem type F6
union nut with rotating thread

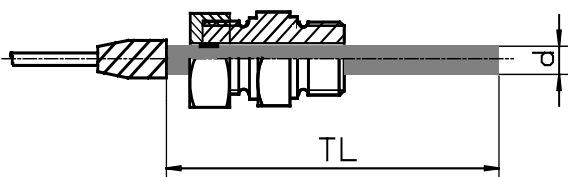

Stem type F7
plain stem, smooth with clamping nut

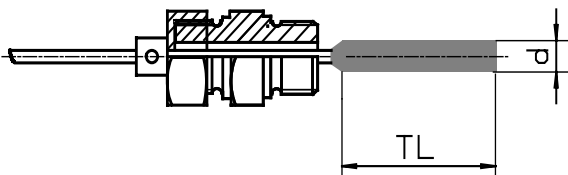

Stem type F7-1
displacable union nut
on capillary with clamping nut

Stem type	Minimum Stem length TL								
	F1, F5			F4, F4-1, F6, F7-1			F7		
Stem diameter	12	10	8	12	10	8	12	10	8
Temperature range									
<500°C	40	50	80	50	60	90	70	80	105
>500 °C	80	110	170	90	120	180	110	145	195